

MONUMENT RECORD
State of Indiana - County of Monroe

Section: 19

Township: 8 North

Range: 1 East

Corner ID: Sa Cr C-15

Monument Description & Remarks: Found Sandstone with "+" at center of section. Stone was wrapped in flagging and measured 1.30' (h) x 0.88' (l) x 0.37' (w).

References on file in the County Surveyor's Office: Survey in Morgan Monroe State Forest, dated March 1, 1986, prepared by Smith Quillman Associates. Legal Survey Book #2, Page 268-269.

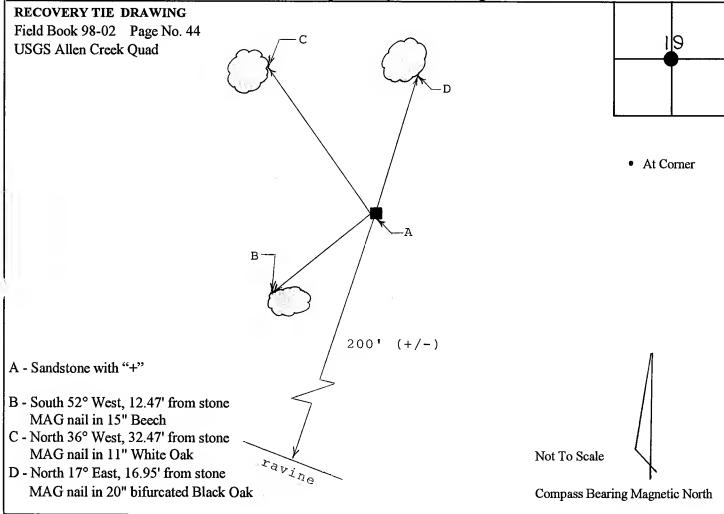

I, Kevin P. Enright, Monroe County Surveyor, hereby certify that this document was prepared under my direction in accordance with the provisions of Section 36-2-12-11 of the Indiana Code; and the above data is given under my hand and seal this 3rd day of December, 1998.

Kevin P. Enright

Administered by Surveyor Review Board

The image contains two circular seals. The top seal is for the 'MONROE COUNTY SURVEYOR' and features the word 'SEAL' in the center. The bottom seal is for the 'SURVEYOR REVIEW BOARD' and also features the word 'SEAL' in the center. Both seals include the text 'MONROE COUNTY INDIANA' around the perimeter.